

QVENTI

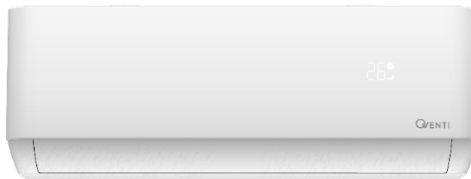

NL *Wifi Gebruikershandleiding*

EN *Wifi instruction manual*



‘Wifi manual Matador serial Airconditioner Qventi’

Wi-Fi Handleiding

Nederlands

Wi-Fi Module specificities en bedieningsinstructies	3
Installeren van de Wi-Fi module(Optional)	4
Downloaden en installeren van de App Smartlife	5
Activeren van de app	6
Registratieprocedure	7
Login	8
Toestel toevoegen.....	9
Air conditioner functies via de app.....	9
Algemene opmerkingen.....	10
Probleem oplossen	10

WiFi module specificaties en bedieningsinstructies

1. Minimale specificities

Android 5.0 versie of hoger
IOS 9.0 versie or hoger

2. Basis parameters for Wi-Fi module

Parameters	Details
Netwerk frequentie	2.400 - 2.4835GHz
Standaarden van WLAN	IEEE 802.11 b/g/n (channels 1-14,channels 1-13 for EU/AU,channels 1-11 for US/CA)
Protocol ondersteuning	IPv4/TCP/UDP/HTTPS/TLS/DNS
Beveiligingsondersteuning	WEP/WPA/WPA2/AES128
Netwerk type support	STA/AP/STA+AP
Max. RF Power	18.5 dbm
Blue tooth frequentie	2.402 - 2.480GHz
Blue tooth RF Power	9 dbm

1. Bedieningsinstructies

Neem onderstaand eenvoudig instructieschema als referentie.

Bewerking stappen	Bewerkings items	Nieuw account	APP opnieuw installeren (eerder geregistreerd)
Stap 1	Download en installeer APP	JA	JA
Stap 2	Activeer APP	JA	JA
Stap 3	Registratie account	JA	NEE
Stap 4	Inloggen	JA	JA
Stap 5	Apparaat toevoegen om te bedienen	JA	Geregistreerd apparaat blijft behouden.

Als u het account en het apparaat eerder hebt geregistreerd en het apparaat hebt toegevoegd, blijft het toegevoegde apparaat bij het opnieuw installeren en inloggen zichtbaar en wordt dan herkend.

Installeren van de Wi-Fi module(Optioneel)

1. Open het voorpaneel van de binnenuit.

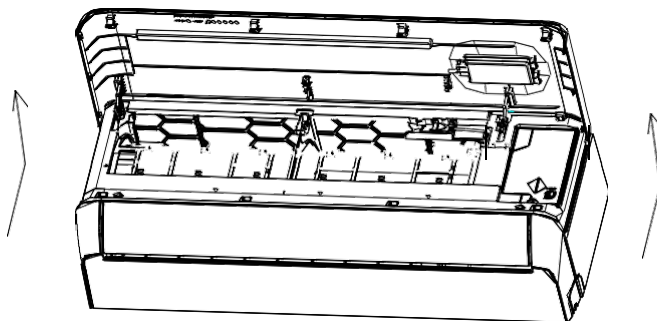

2. Haal de klep van de USB Wi-Fi module eraf, volg de pijl en steek de USB Wi-Fi module in de gereserveerde USB-sleuf in het frame. (zie onderstaande inzet afbeelding)

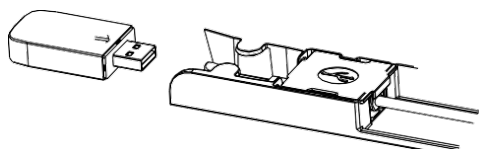
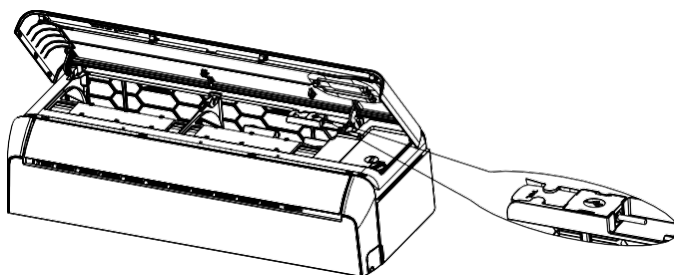

Downloaden en installeren van de App Smartlife



SmartLife-SmartHome

Voor Android smartphone

Methode 1: Scan de QR-code met een browserscanner, download en installeer de APP.

Methode 2: Open de Google "Play Store" op uw smartphone en zoek "SmartLife-SmartHome", download en installeer de APP.



Voor IOS smartphone

Methode 1: Scan de QR-code en volg de tips om in de "AppStore" te komen, download en installeer de APP.

Methode 2: Open de Apple "AppStore" op uw smartphone en zoek "SmartLife-SmartHome", download en installeer de APP.



Notitie:

Schakel de machtigingen van Opslag/Locatie/Camera voor deze APP in tijdens de installatie. Anders zal het mogelijk problemen geven bij het installeren en/of gebruik.

Activeer de APP

De eerste keer dat de app wordt gebruikt, moet deze worden geactiveerd.

1. Start de APP "Smart Life" op uw smartphone.



SmartLife-Smarthome

2. Methode1: Druk op de knop "Scannen" en scan de juiste QR-code activeren

Methode2: Tik op "of Voer activeringscode in" onder aan het scherm, voer vervolgens de activeringscode in en tik op "BEVESTIGEN".

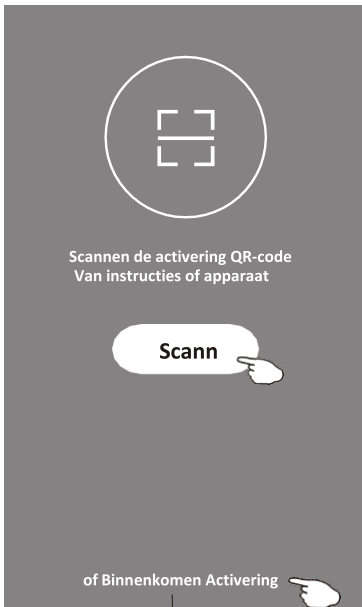

QR-code en activeringscode activeren



Opmerking Zonder de QR-code of activeringscode kunt u de APP niet activeren en als u deze gebruikt, moet u ze veilig houden.

Registreren

1. Als u geen account heeft, tikt u op de knop "Registreren".
2. Lees het Privacybeleid en tik op "Akkoord".

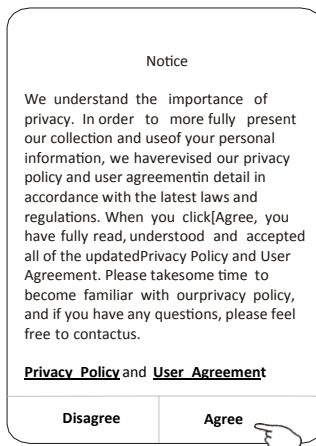
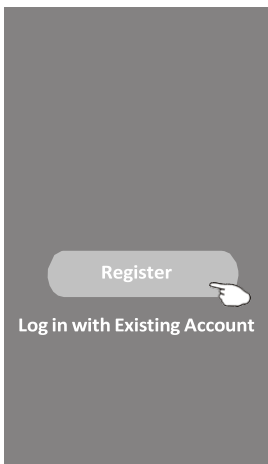

3. Tik op ">" en kies het land.
4. Vul uw e-mailadres in.
5. Tik op de knop "Verificatiecode verkrijgen".

Zoek in het land of schuif het scherm omhoog/omlaag om te vinden en kies het land.

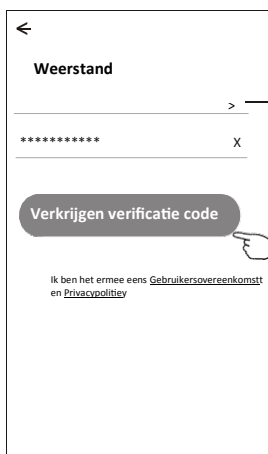

vul hier uw e-mailadres in

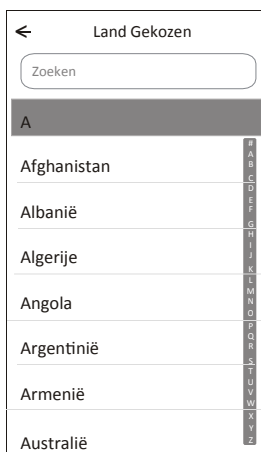

6. Voer de verificatiecode in die u per e-mail hebt ontvangen.
7. Stel het wachtwoord in met 6-20 tekens, inclusief tekens en cijfers.
8. Tik op "Gereed".

Login

1. Tik op "Inloggen met bestaand account".
2. Voer uw geregistreerde account en wachtwoord in.
3. druk op de "Log in" knop.

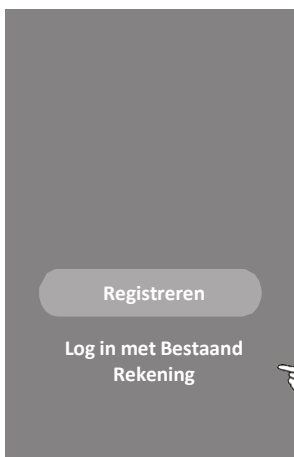

A white rectangular area representing a mobile app screen. At the top left is a back arrow. Below it is the title "Login". There are three input fields: the first contains "*****" and has a right-pointing arrow; the second contains "*****"; the third contains "*****". Below the fields is a dark grey rounded button labeled "Log in", with a hand icon pointing to it. Underneath the button is the text "Forgot password". At the bottom, there is a small line of text: "Login means that you agree with [User Agreement](#) and [Privacy Policy](#)".

voer hier uw account in
voer hier het
wachtwoord in

Toestel toevoegen

Nadat download van de APP, de registratie en de loginprocedure zijn voltooid, dienen er nog een aantal stappen te worden doorlopen;

- Voeg het toestel toe, van waaruit de app wordt bestuurd om verbinding te maken met de airconditioner.
- Zie onderstaand schema waar de 'airconditioner (Wi Fi)' kan worden gevonden, om toe te voegen.

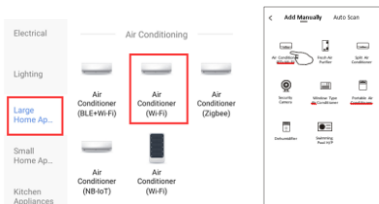

- Hierna kan er worden gestart het bedienen van de app.
- Zo kan je onderstaande instellingen verrichten voor een optimaal (energie)gebruik en comfort:
 - o Account informatie beheren
 - o Profiel van de gebruiker instellen
 - o Temperatuurinstelling (van 16 tot en met 31 graden)
 - o Timerfunctie (wanneer inschakelen en wanneer uitschakelen, welk programma, stand etc)
 - o Aan – uitschakeling (Aan/uitfunctie)
 - o Selecteer de gewenste modus (Koelen, verwarmen, ontvochtigen, ventileren of auto)
 - o Selecteer het gewenste programma (Eco, Sleep, Turbo)
 - o Selecteer de gewenste ventilatorsnelheid (low, mid, high en auto)
 - In sommige automatische programma's is de ventilatorsnelheid niet verder te verfijnen
 - Maak de instellingen geheel eigen voor eigen wensen en behoeften.
- Voor meer details en schematische weergaven verwijzen we naar de uitgebreidere Engelse handleiding, Die voorzien is van meer scherm(voor)beelden.

Algemene opmerkingen

- Voor technische updates is er mogelijk een afwijking ten opzichte van de werkelijke items van wat er in deze handleiding staat. Raadpleeg uw werkelijke product en APP.
- De airconditioner APP kan zonder kennisgeving worden gewijzigd voor kwaliteitsverbetering en ook worden verwijderd, afhankelijk van de omstandigheden van productiebedrijven.
- In het geval dat de wi-fi-siginaalsterkte is verzwakt, kan de slimme app worden losgekoppeld. Zorg er dus voor dat de binneneenheid in de buurt van de draadloze router staat.
- DHCP-serverfunctie moet worden geactiveerd voor draadloze router.
- De internetverbinding kan mislukken vanwege een firewallprobleem. Neem in dit geval contact op met uw internetprovider.
- Voor de beveiliging van het smartphonesysteem en de netwerkinstelling moet u ervoor zorgen dat de APP van de slimme airconditioner wordt vertrouwd.

Problemen oplossen

Beschrijving klacht	Mogelijke analyse en aanleiding van de oorzaak
Airconditioner kan niet met succes worden geconfigureerd	<p>1. Controleer of de SSID (Service Set Identifier) is de naam van je netwerk) en het wachtwoord van het apparaat dat verbonden dient te zijn met de WLAN-router correct zijn;</p> <p>2. Controleer of er aanvullende instellingen van de WLAN-router zijn, zoals hieronder weergegeven.</p> <ol style="list-style-type: none">1) Firewall via router zelf of via pc2) MAC-adresfiltering3) Verborgen SSID4) DHCP-server <p>Start de WLAN-router, het mobiele apparaat en de airconditioner (WLAN-module) opnieuw op en sluit de airconditioner opnieuw aan via de CF-modus. Controleer voordat u het opnieuw opstart of er niemand al verbinding heeft gemaakt met dezelfde airconditioner.</p>
De airconditioner kan niet per mobiel worden bediend.	<p>Wanneer de airconditioner (WLAN-module) opnieuw wordt opgestart en de app geeft 'Apparaat verwijderen' weer, het negeren van deze bevestiging zal ertoe leiden dat het mobiele apparaat de controletoestemming van de airconditioner verliest. U moet de airconditioner opnieuw aansluiten via de CF-modus.</p> <p>In geval van stroomuitval verliest het mobiele apparaat de controletoestemming van de airconditioner gedurende 3 minuten na stroomuitval. (Een melding verschijnt nu op het mobiele apparaat).</p> <p>Als u de app (airconditioner) niet kunt bedienen, zelfs niet nadat de stroom is hersteld, moet u de airconditioner opnieuw aansluiten via de CF-modus.</p>

<p>Mobiel kan geen airconditioner vinden</p>	<p>1. Smart Life App-weergave 'Airconditioner Apparaat offline'. Controleer de volgende voorwaarden.</p> <ol style="list-style-type: none">1) De airconditioner is opnieuw geconfigureerd.2) Airconditioner heeft geen stroom.3) Router heeft geen stroom.4) Airconditioner kan geen verbinding maken met de router.5) Airconditioner kan geen verbinding maken met het netwerk via de router.6) Mobiel apparaat kan geen verbinding maken met het netwerk. <p>2. Nadat het apparaat is toegevoegd, verdwijnt het in de apparatenlijst. Zorg dat de apparatenlijst vernieuwd wordt (of nogmaals geladen). Als er geen verandering is, sluit u de app af en begint u opnieuw.</p>
--	---

Wi-Fi Manual

English

Statements

Federal Communication Commission Interference Statement

This device complies with part 15 of the FCC Rules. Operation is subject to the following two conditions:

(1) This device may not cause harmful interference, and (2) this device must accept any interference received, including interference that may cause undesired operation .

Any Changes or modifications not expressly approved by the party responsible for compliance could void the user's authority to operate the equipment .

Note: This equipment has been tested and found to comply with the limits for a Class B digital device, pursuant to part 15 of the FCC Rules. These limits are designed to provide reasonable protection against harmful interference in a residential installation. This equipment generates uses and can radiate radio frequency energy and, if not installed and used in accordance with the instructions, may cause harmful interference to radio communications. However, there is no guarantee that interference will not occur in a particular installation. If this equipment does cause harmful interference to radio or television reception, which can be determined by turning the equipment off and on, the user is encouraged to try to correct the interference by one or more of the following measures:

-Reorient or relocate the receiving antenna.

-Increase the separation between the equipment and receiver.

-Connect the equipment into an outlet on a circuit different from that to which the receiver is connected.

-Consult the dealer or an experienced radio/TV technician for help.

FCC Radiation Exposure Statement

This equipment complies with FCC radiation exposure limits set forth for an uncontrolled environment . This equipment should be installed and operated with minimum distance 20cm between the radiator & your body.

RF Exposure: A distance of 20cm shall be maintained between the antenna and users, and the transmitter module may not be co-located with any other transmitter or antenna.

ISED Statement

Innovation, Science and Economic Development Canada ICES-003 Compliance Label :

CAN ICES-3 (B)/NMB-3(B)

This device contains licence-exempt transmitter(s)/receiver(s) that comply with Innovation, Science and Economic Development Canada's licence-exempt RSS(s). Operation is subject to the following two conditions :

1. . This device may not cause interference.

2. This device must accept any interference, including interference that may cause undesired operation of the device.

This equipment complies with ISED RSS-102 radiation exposure limits set forth for an uncontrolled environment. This equipment should be installed and operated with a minimum distance of 20cm between the radiator and any part of your body.

CONTENTS

Wi-Fi Module specification and Operation guideline	15
Install the Wi-Fi module(Optional)	16
Download and Install the App.....	17
Activate APP	18
Registration	19
Login	20
Add device.....	23
Air conditioner control.....	26
Account management.....	41
Trouble Shooting	43

Wi-Fi Module specification and Operation guideline

Minimum specifications on a Smart phone:

Android 5.0 version or higher

IOS 9.0 version or higher

Basic parameters for Wi-Fi module

Parameters	Details
Network frequency	2.400 - 2.4835GHz
Standards of WLAN	IEEE 802.11 b/g/n (channels 1-14, channels 1-13 for EU/AU, channels 1-11 for US/CA)
Protocol stack support	IPv4/TCP/UDP/HTTPS/TLS/DNS
Security support	WEP/WPA/WPA2/AES128
Network type support	STA/AP/STA+AP
Max. RF Power	18.5 dbm
Blue tooth frequency	2.402 - 2.480GHz
Blue tooth RF Power	9 dbm

Operation guideline. Please take below simple guideline instruction as reference.

Operation Steps	Operation Items	New Account	Re-install APP (registered before)
Step 1	Download and Install APP	YES	YES
Step 2	Activate APP	YES	YES
Step 3	Registration Account	YES	NO
Step 4	Login	YES	YES
Step 5	Add Device to control	YES	Registered Device will remain.

Note:

If you registered the account and added device before, when you re-install the APP again and login, the added device will remain .

Install the Wi-Fi module(Optional)

1. Open the panel of indoor unit.

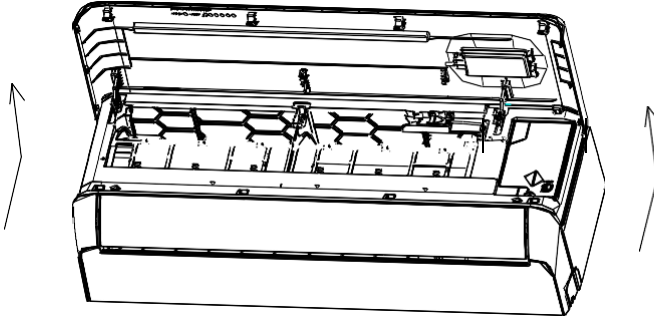

2. Take off the cover of USB Wi-Fi, follow the arrow and insert the USB Wi-Fi module into the reserved USB slot on the frame.

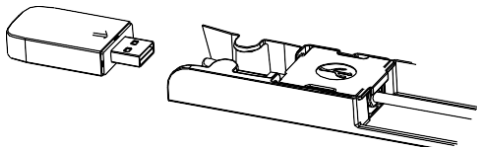
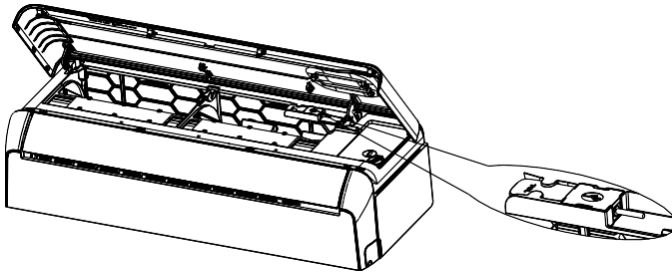

Download and Install the App



SmartLife-SmartHome

For Android smart phone

Method1: Please scan the QR code with a browser scanner, download and install the APP.

Method2: Open the Google "Play Store" on your smart phone and search "SmartLife-SmartHome", download and install the APP.



For IOS smart phone

Method1: Please scan the QR code and follow the tips to get into "AppStore", download and install the APP.

Method2: Open the Apple "AppStore" on your smart phone and search "SmartLife-SmartHome", download and install the APP.



Note:

Please enable the permissions of Storage/Location/Camera for this APP when installing. Otherwise it will have some problems when operating.

Activate APP

The first time the app is used, it will need activating.

1. Launch the APP "Smart Life" on your smart phone.



SmartLife-SmartHome

2. Method1: Tap button "Scan" and scan the right Activate QR code
Method2: Tap "or Enter Activation Code" in bottom of the screen, then enter the activate code and tap "CONFIRM".

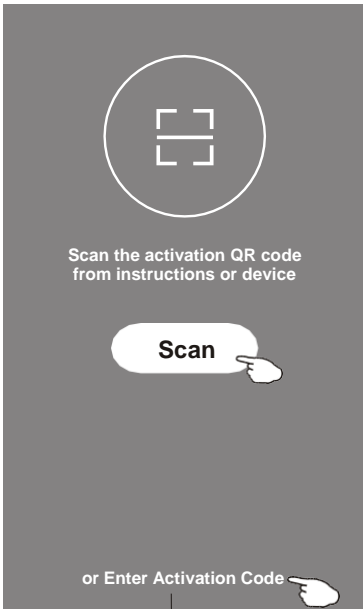

Activate QR code and activation code



Note: Without the QR code or activation code, you can't activate the APP and using it, please keep them safe.

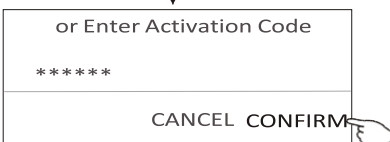

Registration

1. If you don't have any account please tap button "Register".
2. Read the Privacy Policy and tap "Agree".

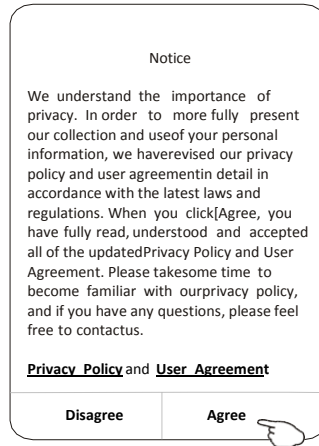
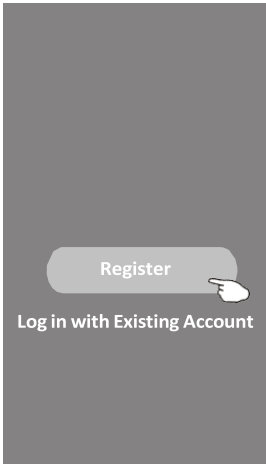

3. Tap ">" and choose the country.
4. Enter your e-mail address.
5. Tap the button "Obtain verification code".

Search the country or slide the screen up/down to find and choose the Country.

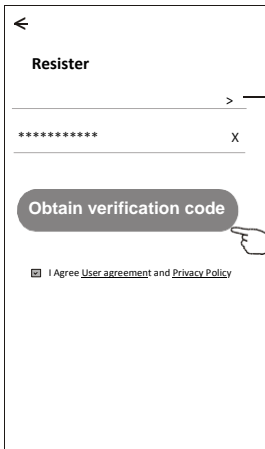

enter your e-mail address here

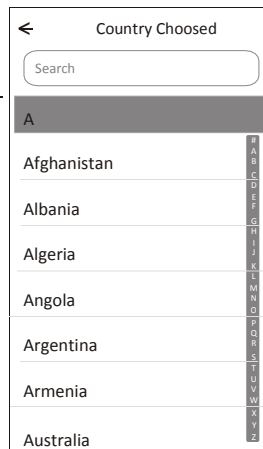

Registration

6. Enter the verification code you received from e-mail.
7. Set the Password with 6-20 characters including characters and numbers.
8. Tap "Done".

Login

1. Tap "Log in with existing account".
2. Enter your registered account and password.
3. Tap "Log in" button.

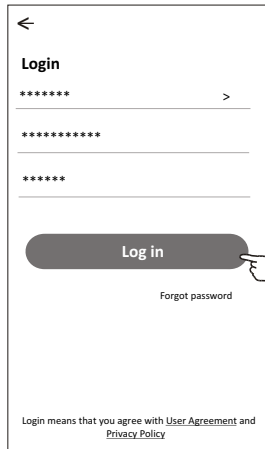
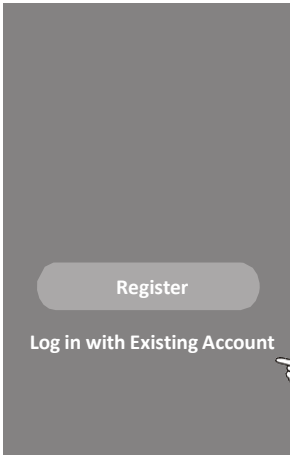

enter your account here

enter the password

Login

The first time the APP is used, Create family is needed:

4. Tap "Create family".
5. Make name for the family.
6. Set the location.
7. Choose default rooms or add new rooms.
8. Tap "Done" and "Completed".



Family created successfully
View family Completed

choose the recommended room or make a new room, then tap Done.

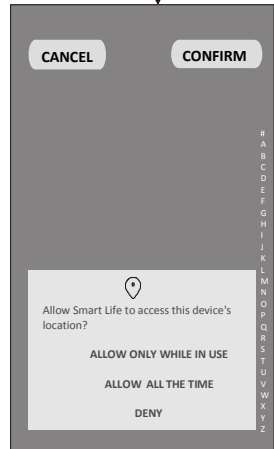
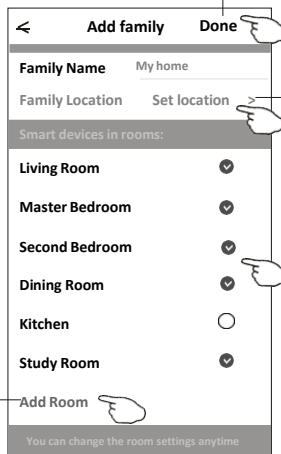
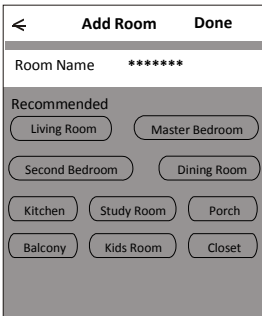

Note:
The app can open the map on your phone and you can set the location where you are.

Login

Forgot the password

If you forgot the password or you want to reset the password, operate as below:

1. Tap "Forgot password".
2. Enter your account(e-mail address) and tap button "Obtain verification code".
3. Enter the verification code received by your e-mail.
4. Set the new password and tap button "Done".

←

Login

***** >

Email address

Password

Log in

[Forgot password](#)

Login means that you agree with [User Agreement](#) and [Privacy Policy](#)

←

Forgot password

***** >

***** X

Obtain verification code

←

Enter verification code

* * * * *

Verification code is sent to your email:
***** ,Resend(55s)

←

Set Password

***** >

6-20 characters for password, including character, numbers

Done

Add device

There are 3 methods to add the device.

1-CF mode

1. Power on the indoor unit, no need to launch the air conditioner.
2. Click "+" in the upper right corner of the "Home" screen or tap "Add device" on the room which has no device.
3. Tap the "Air conditioner(BT+Wi-Fi)" logo.
4. Follow the comments on the next screen to reset the Wi-Fi module then check "Confirm the device is reset" and tap "Next".
5. Input the password of the Wi-Fi which the same as your smart phone connected, then tap "Next".
6. You can see the percent rate of connecting process, at the same time "PP", "SA", "AP" shining in turn on the indoor display. "PP" means "Searching the router" "SA" means "connected to the router" "AP" means "connected to the server"

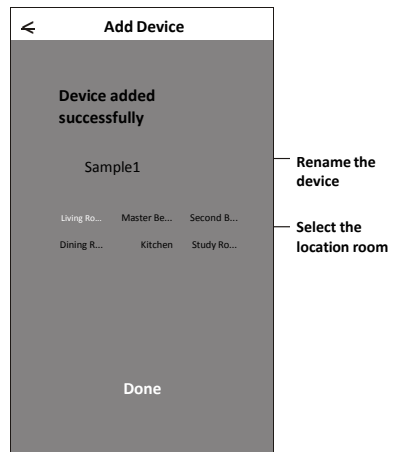
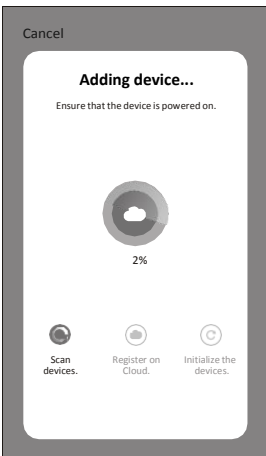
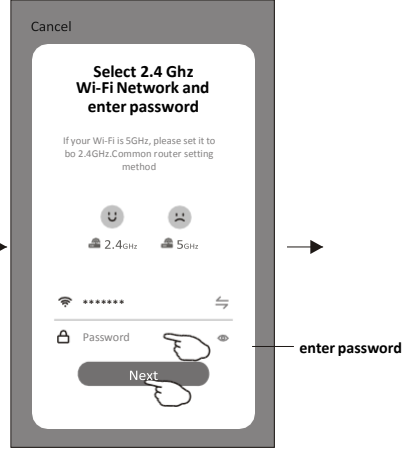
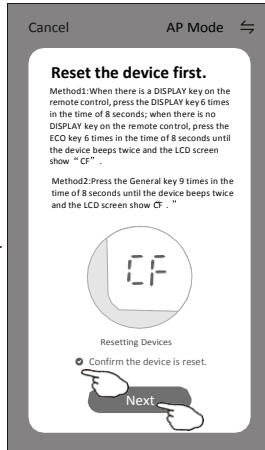
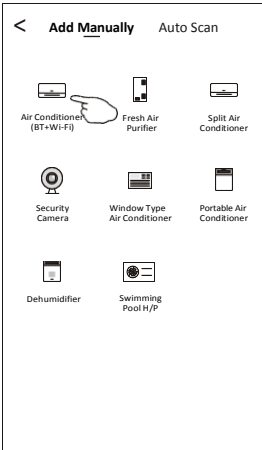
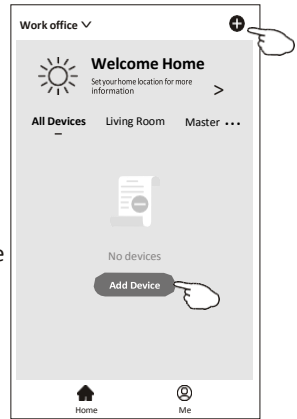

Add device

There are 3 methods to add the device.

2-AP mode

1. Power on the indoor unit, no need to launch the air conditioner.
2. Click "+" in the upper right corner of the "Home" screen or tap "Add device" on the room which has no device.
3. Tap the "Air conditioner(BT+Wi-Fi)" logo.
4. Tap \Rightarrow in the upper right corner and choose "AP Mode" then follow the comments on the screen to reset the Wi-Fi module then check "Confirm the device is reset" and tap "Next".
5. Input the password of the Wi-Fi which the same as your smart phone connected, then tap "Next".
6. Read the instruction carefully and tap "Connect now".
7. In the network setting screen, select "SmartLife-****", and tap " \leftarrow ".
8. You can see the percent rate of connecting process, at the same time

"PP" means "Searching the router"

"SA" means "connected to the router"

"AP" means "connected to the server"

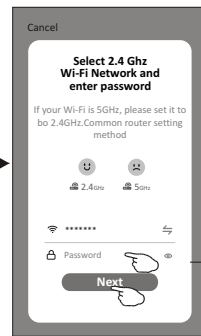
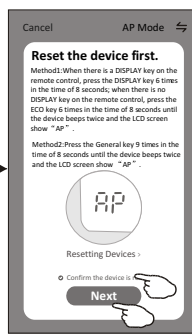
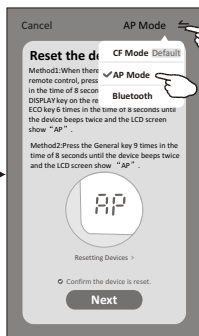
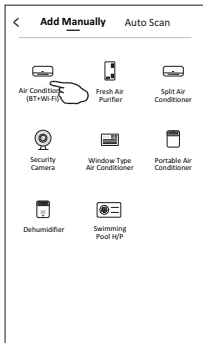
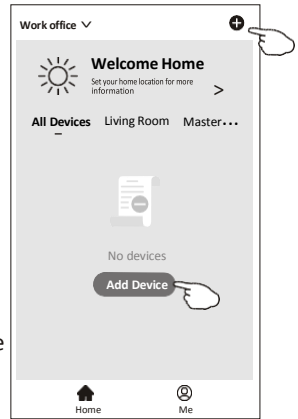

enter password

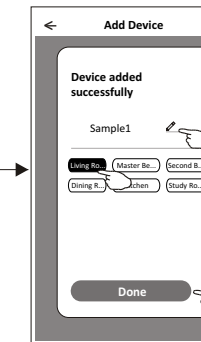
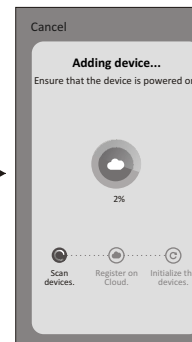
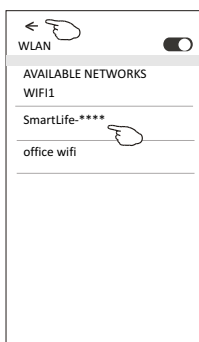
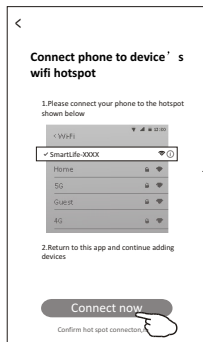

Rename the device

Select the location room

Add device

There are 3 methods to add the device.

3-Blue tooth mode

1. Power on the indoor unit, no need to launch the air conditioner.
2. Click "+" in the upper right corner of the "Home" screen or tap "Add device" on the room which has no device.
3. Tap the "Air conditioner(BT+Wi-Fi)" logo.
4. Make sure Blue tooth of your smart phone is available.
5. Tap \approx in the upper right corner and choose "Bluetooth" then follow the comments on the screen to reset the Wi-Fi module then check "Confirm the blue tooth is reset" and tap "Next".
6. Select one of the found device and tap "+"
7. Input the password of the Wi-Fi which the same as your smart phone connected, then tap "Next".
8. You can see the percent rate of connecting process, at the same time "PP", "SA", "AP" shining in turn on the indoor display.

"PP" means "Searching the router"

"SA" means "connected to the router"

"AP" means "connected to the server"

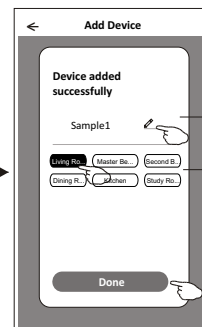
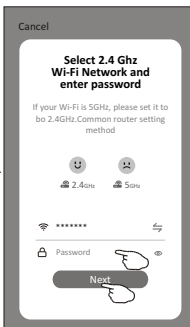
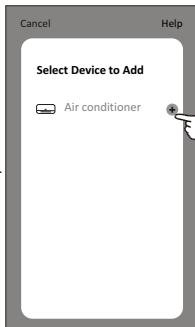
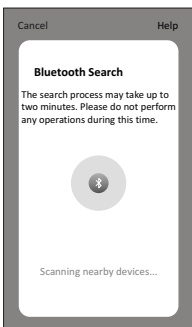
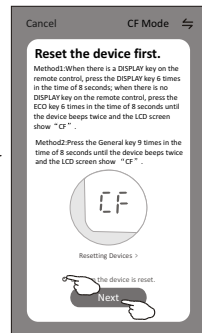
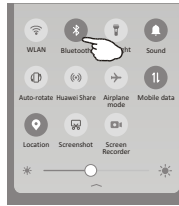
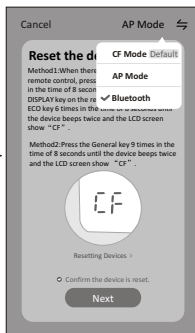
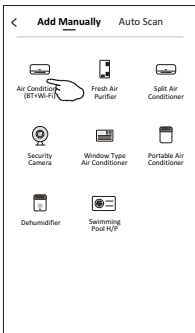
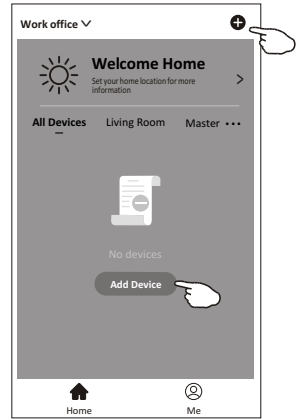

Rename the device

Select the location room

Air conditioner control

The device control screen will pop up automatically after adding the device.

The device control screen will pop up manually by tapping the device name on the home screen.

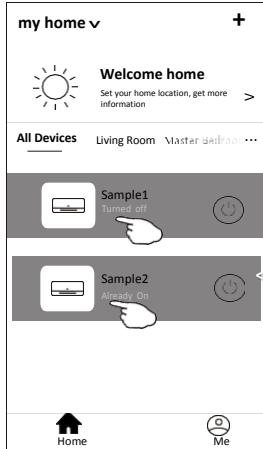

Note:

There are two different control forms base on different software or Wi-Fi module firmware. Please read the manual carefully base on the real control interface.

Control form1

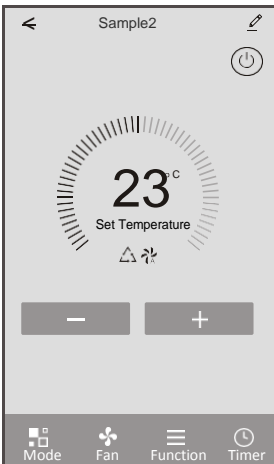

Control form2

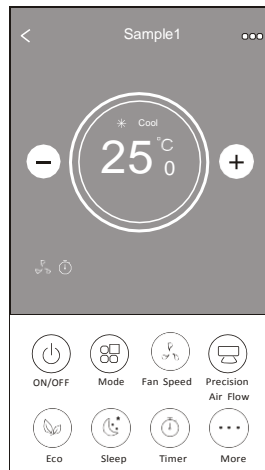

Air conditioner control

Control form1

The main control interface

Back to the Home screen



Sample2



Device details and management



Turn ON/OFF the air conditioner

Indicator of setting temperature



Selected Mode/Fan speed/ Functions indicator



Decrease the setting temperature



Increase the setting temperature



Air conditioner control

Control form1-Mode setting

1. Tap Mode to pop up the Mode screen.
2. Select one of the mode Feel/Cool/Heat/Dry/Fan.
3. Tap anywhere around the setting temperature to cancel the Mode setting.

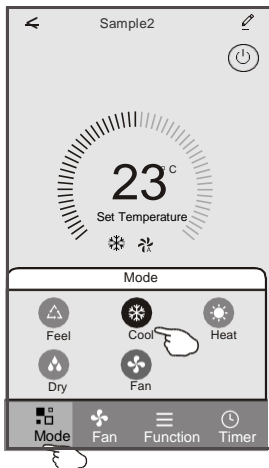

Control form1-Select fan speed

1. Tap Fan to pop up the Fan screen.
2. Select one of the fan speed High/med/Low/Auto.
3. Tap anywhere around the setting temperature to cancel the selection.

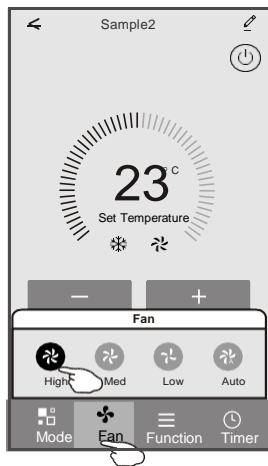

Control form1-Function setting

1. Tap Function to pop up the Function screen.
2. Select one of the functions Sleep/Turbo/ECO.
3. Select UP-DOWN/LEFT-RIGHT for auto swing with direction of UP-DOWN/LEFT-RIGHT.
4. Tap anywhere around the setting temperature to cancel the Function setting.

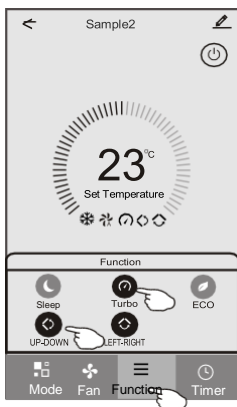

Control form1-Timer adding

1. Tap Timer to pop up the Add Timer screen.
2. Tap Add Timer.

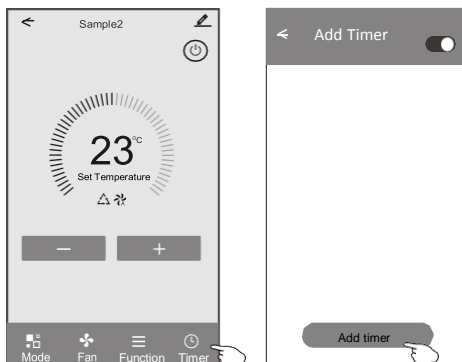

Air conditioner control

Control form1-Timer adding

3. Select the time, select the repeat days and Timer on/off.
4. Select the Mode/Fan speed/Function and select the setting temperature for Timer on.
5. Tap Save to add the timer.

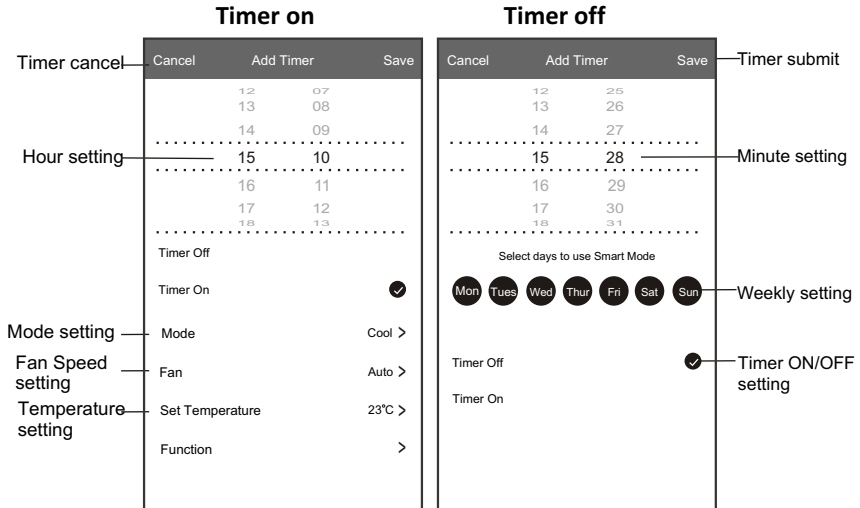

Control form1-Timer Management

1. Tap the bar of timer to edit the Timer like the Timer adding process.
2. Click the switch to enable or disable the Timer.
3. Holdind the bar of Timer about 3seconds and pop up the Remove Timer screen, tap CONFIRM and remove the Timer.

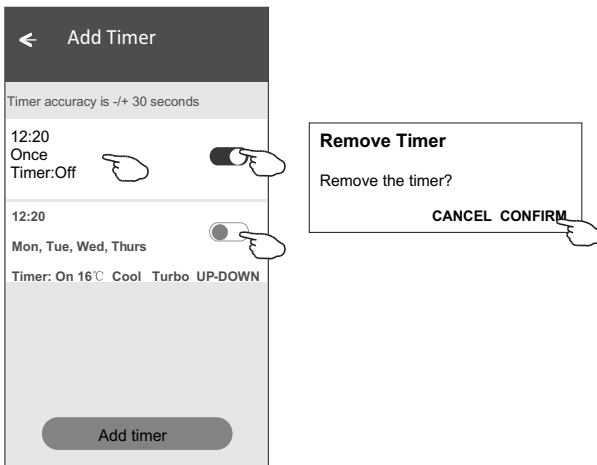

Air conditioner control

Control form2

The main control interface

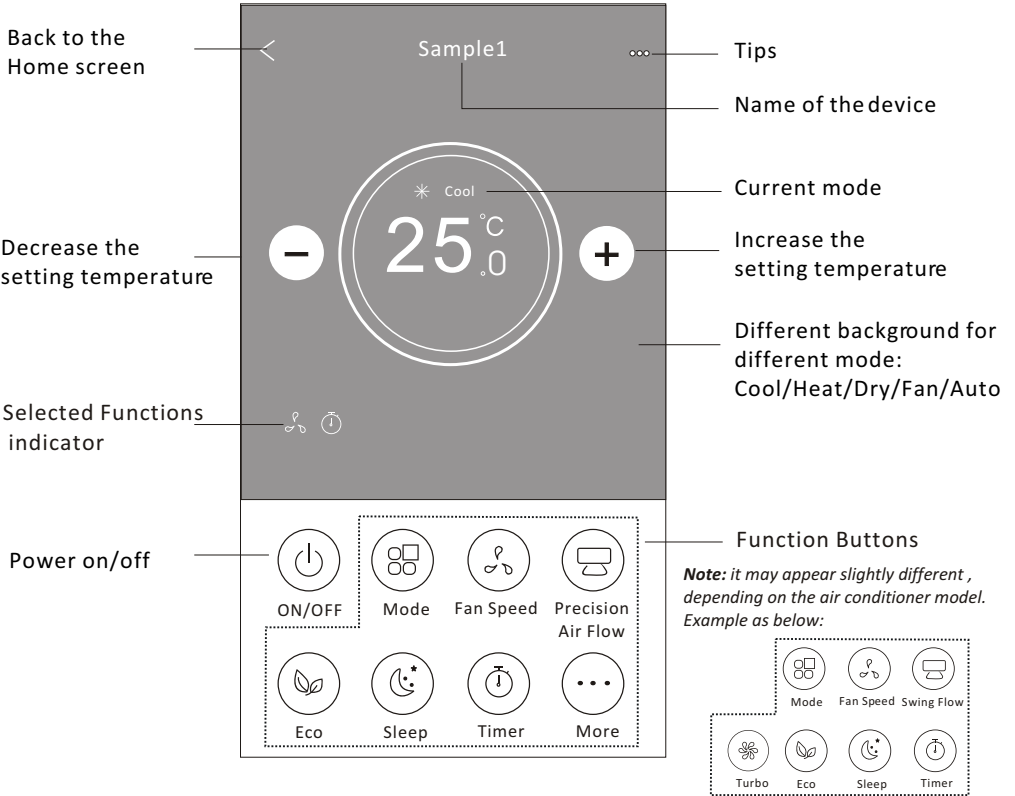

Air conditioner control

Control form2-Mode setting

1. Tap the Mode button.
2. There are 5 modes on the Mode screen, tap one button to set the Air conditioner working mode.
3. Tap the X button to back the main control screen.
4. The mode and background will change on the screen.

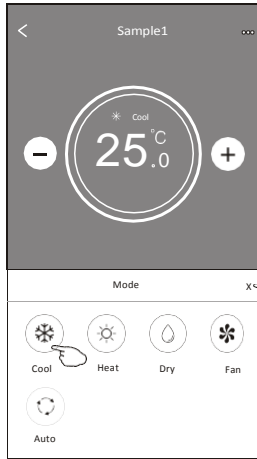
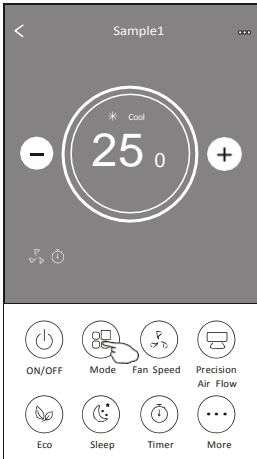

Note: please read the details of each mode in the user manual to control more comfortable.

Control form2-Fan speed selection

1. Tap the Fan speed button.
2. Choose your desired fan speed and tap it.
3. Tap the X button to back the main control screen.
4. The selected fan speed indicator will appear on the screen.

Mode	Fan Speed
Cool	All speeds
Fan	All speeds
Dry	
Heat	All speeds
Auto	All speeds

Note:
Fan Speed can't be adjusted on Dry mode .

Note: Fan Speed screen may appear slightly different , depending on the air conditioner model.
Example as below:

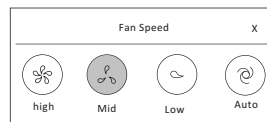
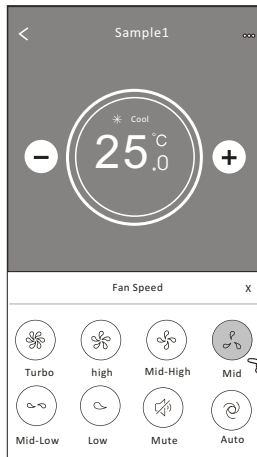
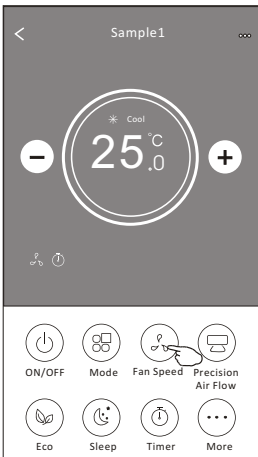

Air conditioner control

Control form2-Air Flow control

1. Tap the Precision Air Flow button or Swing Flow button.
2. Choose your desired air flow and tap it.
3. Tap the X button to back to the main control screen.
4. The selected air flow indicator will appear on the screen.

Note: For some models without auto Left-Right wind, If you active it, you will hear a beep, but no any actions.

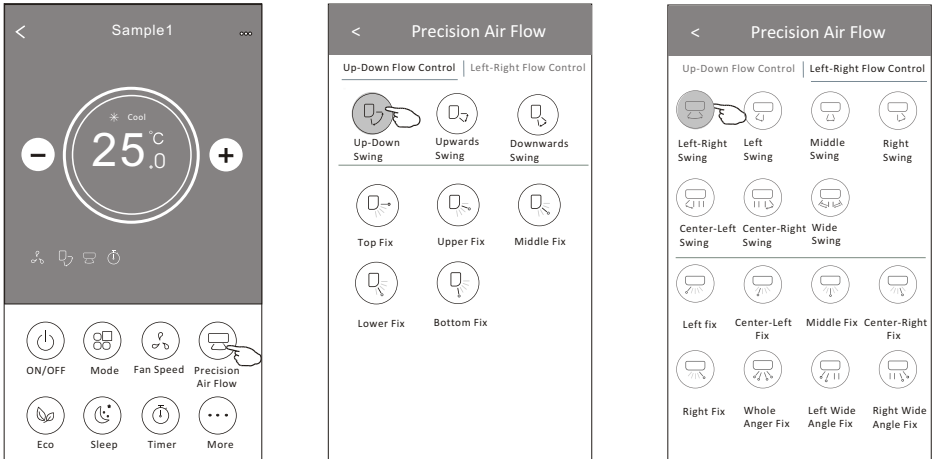

Note: The Main controlscreen and Air Flow screen may appear slightly different, depending on the air conditioner model. Examples below:

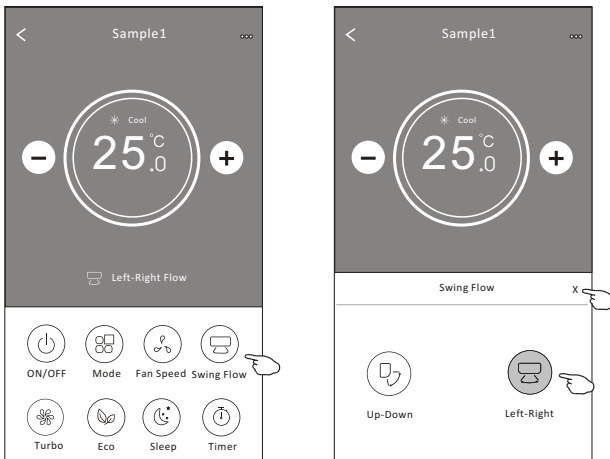

Air conditioner control

Control form2-ECO function

1. For Eco function, just tap the button to activate the function, the button will be lighting and the indicator will appear on the screen.
2. Tap again to disable the function.
3. Temperature controlled for some air conditioner model:
 In Cooling mode, the new setting temperature will $\geq 26^{\circ}\text{C}$.
 In heating mode, the new setting temperature will $\leq 25^{\circ}\text{C}$.

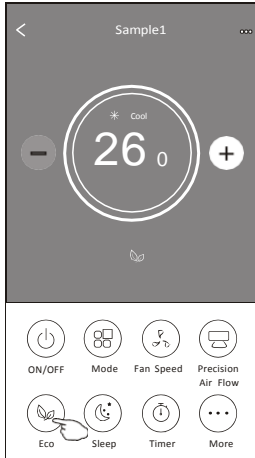
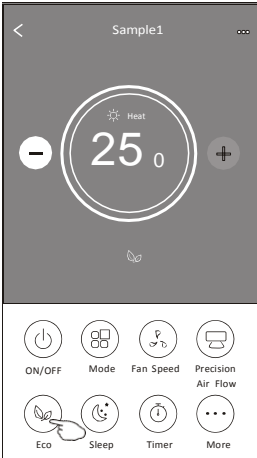

Mode	ECO enabled
Cool	Yes
Fan	
Dry	
Heat	Yes
Auto	

ECO is disabled on Fan/ Dry/Auto mode .

Note: The Main control screen and ECOcontrol method may appear slightly different, depending on the airconditioner model.Example asbelow:

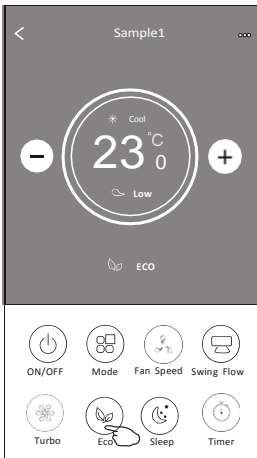

Note:

ECO is disabled on Turbo/Sleep mode too for some air conditioner model.

Air conditioner control

Control form2-Sleep function

1. Tap the Sleep button.
2. Choose your desired sleep mode and tap it.
3. Tap the X button to back to the main control screen.
4. The selected sleep mode indicator will appear on the screen.

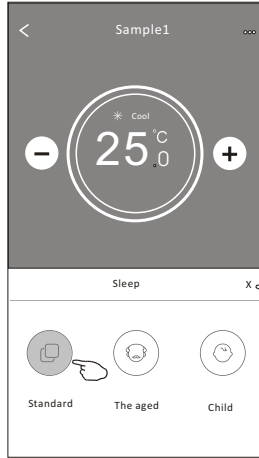
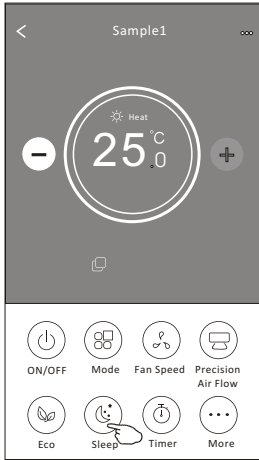

Mode	Sleep enabled
Cool	Yes
Fan	
Dry	
Heat	Yes
Auto	

Sleep is disabled on Fan/ Dry/Auto mode .

Note:

The Main control screen may appear slightly different ,depending on the air conditioner model. Example as below:

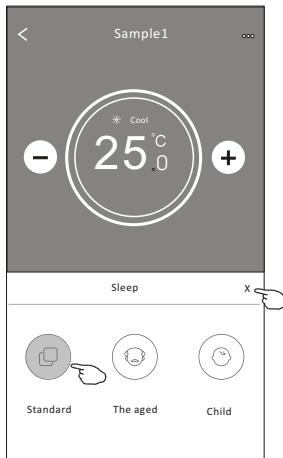
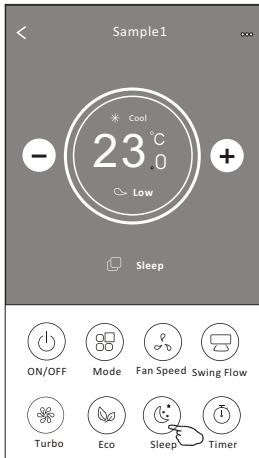

Note:

Sleep is disabled on Turbo/Sleep mode too for some air conditioner model..

Air conditioner control

Control form2-Timer(on) setting

1. Tap the Timer button.
2. Tap + in the upper right corner of the Timer main screen.
3. Choose the Time/Repeat/Switch OFF then tap Save.
4. The timer(off) will appear on the Timer main screen.

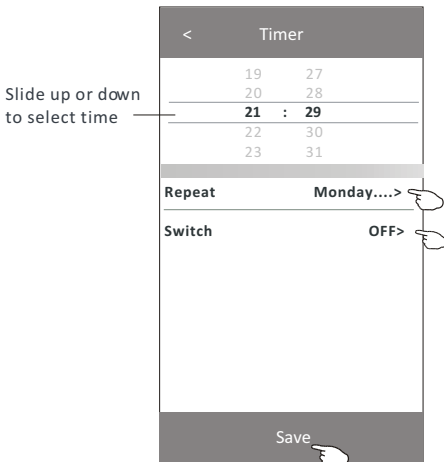
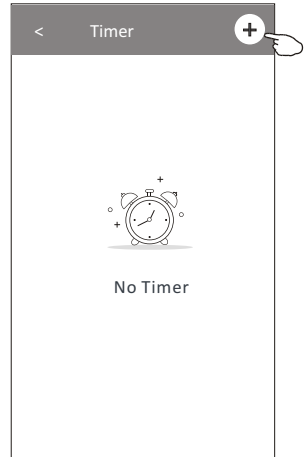
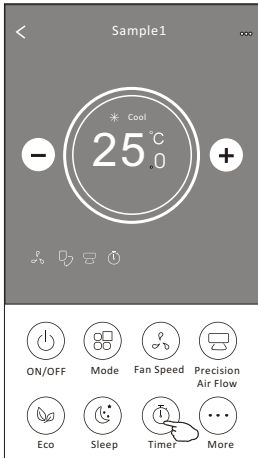

Tap repeat> then tap your desired repeat days or Once, then tap Confirm your selection.

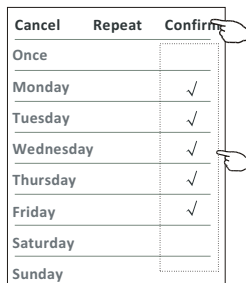

Tap Switch> then slide the screen to choose ON and Confirm.

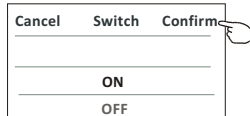

Air conditioner control

Control form2-Timer(off) setting

1. Tap the Timer button.
2. Tap + in the upper right corner of the Timer main screen.
3. Set the Time/Repeat Date/Switch(ON)/Temperature/Mode/
Fan speed/Air Flow as your desired and then tap Save.
4. The timer will appear on the Timer main screen.

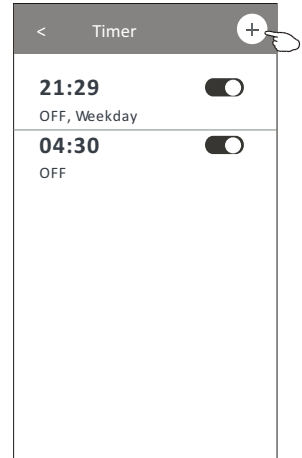
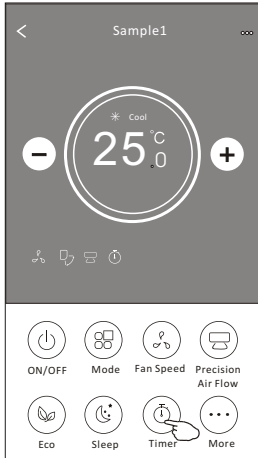

Slide up or down to select time

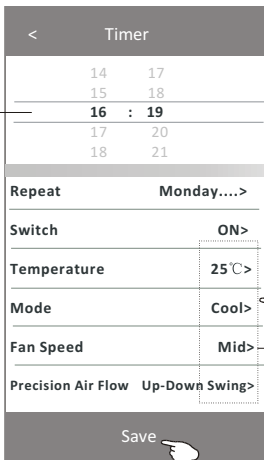

Tap repeat > then tap your desired repeat days or Once, then tap Confirm your selection.

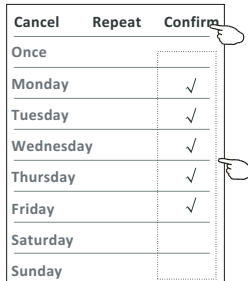

Tap Switch > then slide the screen to choose ON and Confirm.

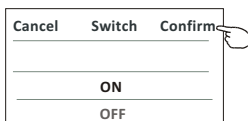

Tap Temperature/Mode/Fan Speed/Air Flow > one by one then set as your desired as mentioned on the previous chapter and tap Confirm the setting.

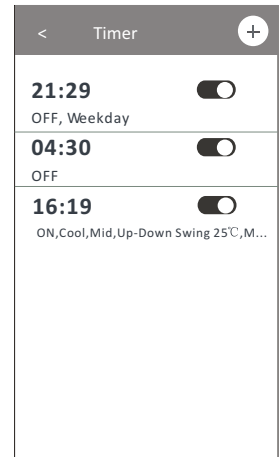

Air conditioner control

Control form2-Timer management

1. Change the Timer setting:

Tap anywhere of the timer list bar except the switch bar to get into the Timer setting screen, change the setting and then tap save.

2. Enable or Disable the Timer:

Tap the left of the switch to disable the Timer.

Tap the right of the switch to enable the Timer.

3. Delete the Timer:

Slide the list bar of the Timer from right to left until Delete button appear, then tap delete.

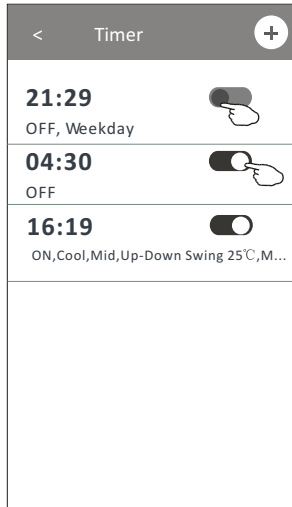
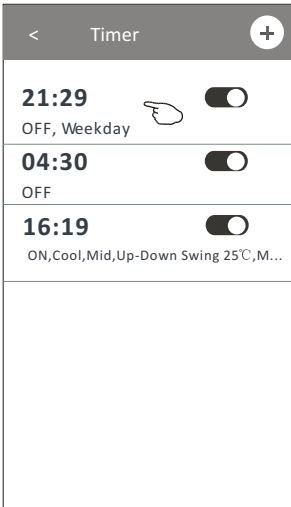

Slid left to disable the Timer.

Slid right to enable the Timer.

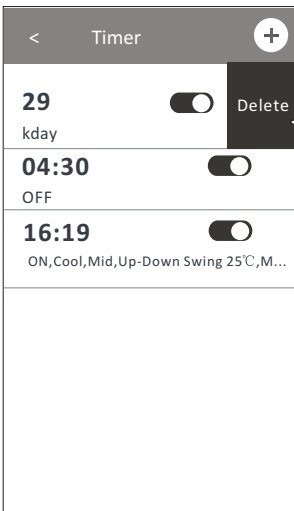

Air conditioner control

Control form2-More functions → Some functions are NOT included!

1. Tap the More button to operate additional functions if it appears on the screen.

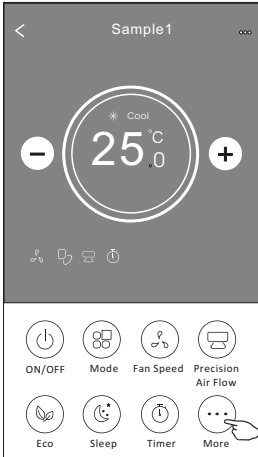

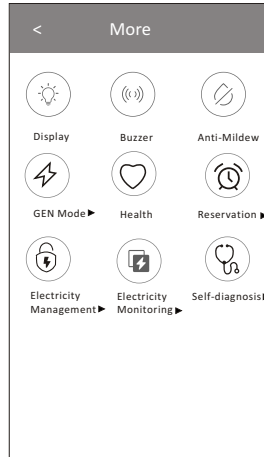

Note:
Some air conditioner model
don't have the more button.



Note: The appearance maybe different, some icons
will be hidden if the air conditional do no have this
function or do not enable on the current mode.

2. Tap the "  " to switch on/off the indoor LED display.
Display

3. Tap the "  " to switch on/off the buzzing when operating through Wi-Fi APP.
Buzzer

4. Tap the "  " button to activate the Anti-Mildew function, if it is available on the screen.
Anti-Mildew

After AC turning off, it will start drying, reduce residual moisture and prevent mould, after function finish, it will automatically turn off.

Air conditioner control

Device details and management

Tap  on control form1 or tap ... on control form2 , get into the device details screen. Here you can get some useful information and sharing the device to other accounts. Check the following pictures and instructions carefully.

Control form1

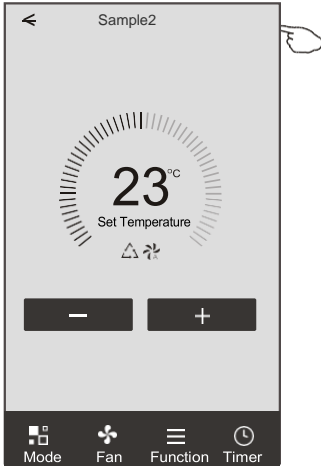

Control form2

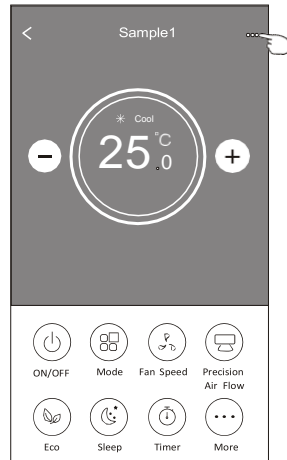

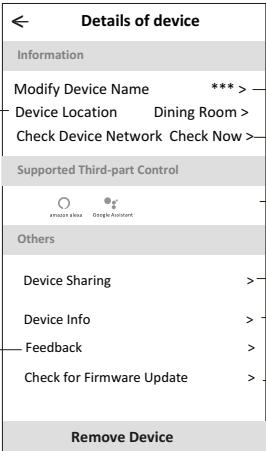
		
Tap to change the device location to another room	<ul style="list-style-type: none"> Modify Device Name *** > Device Location Dining Room > Check Device Network Check Now > 	<ul style="list-style-type: none"> Tap to check the network status Tap to check the network status
	<ul style="list-style-type: none"> Supported Third-part Control <ul style="list-style-type: none"> amazon alexa Google Assistant Others <ul style="list-style-type: none"> Device Sharing > Device Info > Feedback > Check for Firmware Update > Remove Device 	<ul style="list-style-type: none"> Tap to got the instruction for connecting the amazon alexa or Google Assistant voice controller Tap to sharing the device to other account Tap to check the Virtual ID/Wi-Fi name/IP address MAC address/Time Zone/Wi-Fi single strength Check and update the firmware Tap to remove the device and the device will be reset automatically once be deleted.
Feed back the problems or some suggestions to the APP administrator.	Feedback >	

Air conditioner control

Device details and management

How to share the devices to other accounts?

1. Tap "Device Sharing" and pop up Device Sharing screen.
2. Tap "Add Sharing".
3. Select the region and enter the account which you want to sharing.
4. Tap "Completed", the account will appear on your sharing list.
5. The received sharing members should hold pressing the home screen and slide down to refresh the device list, the device will appear on the device list.

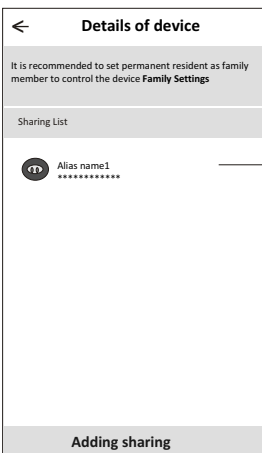
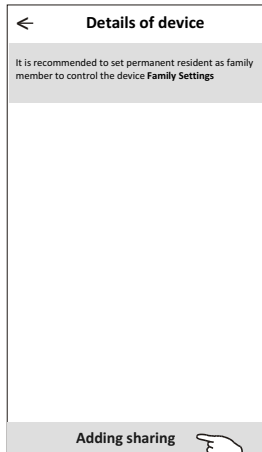
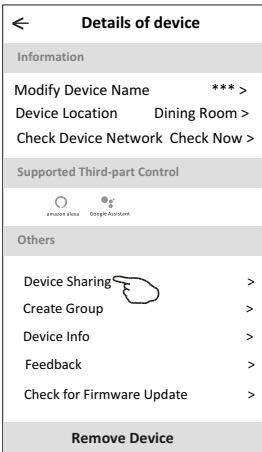

Hold the bar about 3s then you can delete the sharing account.

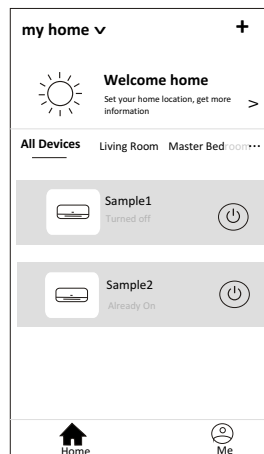

Hold on and slide down to refresh the device list

Account management

Account Profile setting

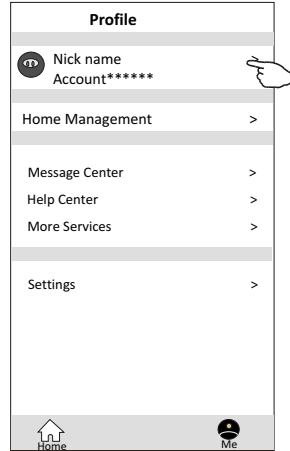
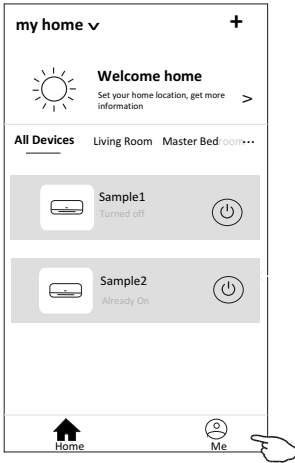

Change the nick name of your account

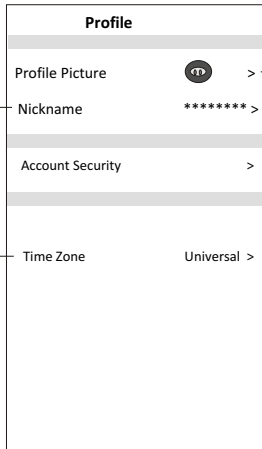
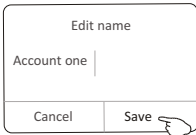

Select a picture for the account from local album

Select the time zone

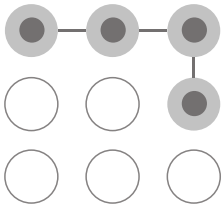

Set a pattern password for launching the APP

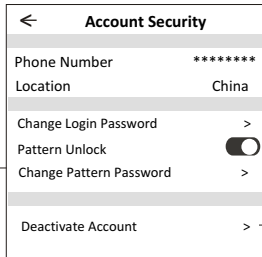

Change the password like reset password on page7

Tap the switch to enable or disable the Pattern password

Please carefully to deactivate the account for all data will be deleted.

Account management

Home(Family) management

1. Tap the name of home at the left upper corner of the Home Screen and select the Home Management.
Or tap Me and tap Home Management.
2. Tap one of the families in the family list and get into Family Settings screen.

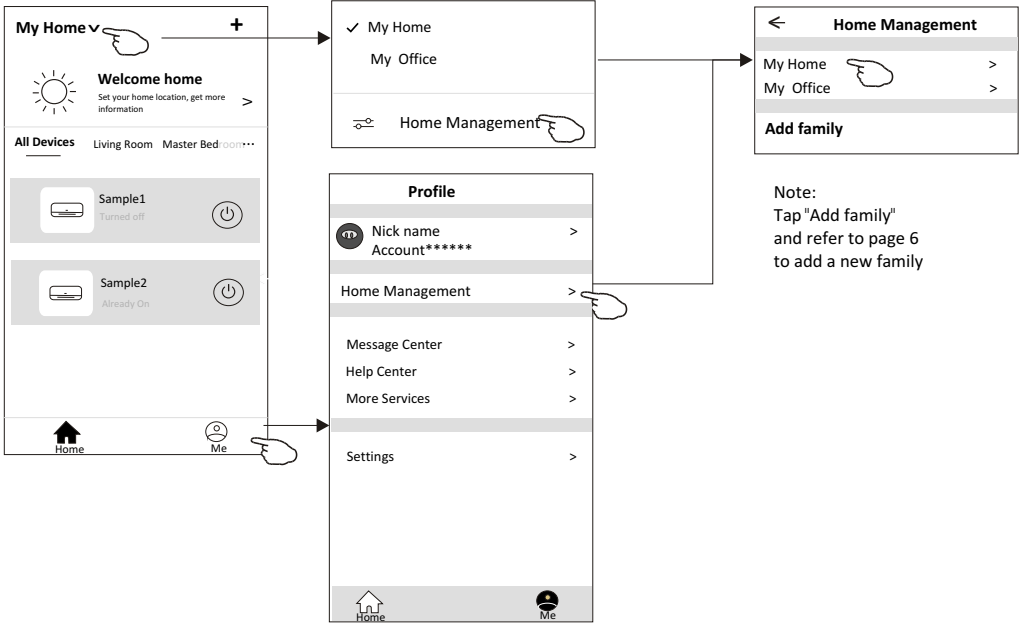

3. Set the family as the following indicators.

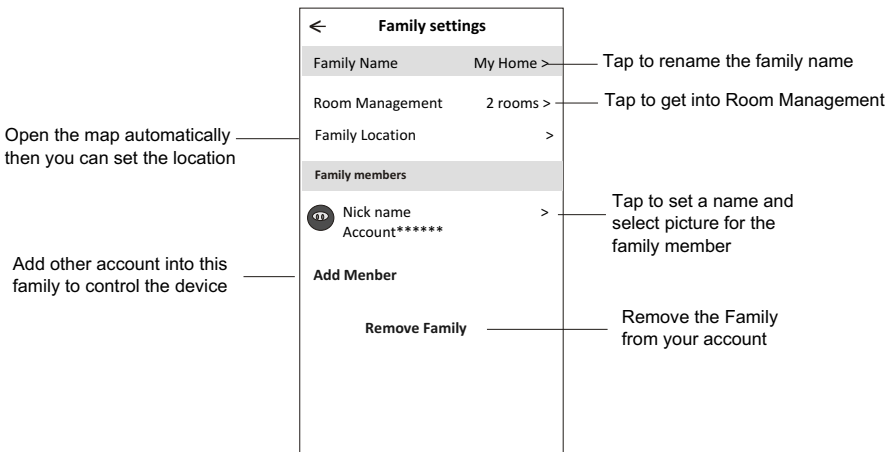

Notice

1. For technical update, there is maybe deviation of the actual items from what is on the manual.
Please refer to your actual product and APP.
2. Smart air conditioner APP can be altered without notice for quality improvement and also be deleted depending on the circumstances of manufacturing firms .
3. In case Wi-Fi signal strength is weakened, smart App may be disconnected. So make sure the indoor unit near to wireless router.
4. DHCP server function should be activated for wireless router.
5. The internet connection may fail because of a firewall problem. In this case, contact your internet service provider.
6. For smart phone system security and network setting, make sure Smart air conditioner APP is trusted.

Trouble Shooting

Description	Analysis of cause
Air conditioner can't be configured successfully	<ol style="list-style-type: none">1. Check the mobile connected WLAN router SSID and password is correct;2. Check whether there are additional settings of WLAN router as shown below.<ol style="list-style-type: none">1) Firewall by router itself or by PC2) MAC address filtering3) Hidden SSID4)DHCP server <p>Reboot WLAN router, mobile device and air conditioner (WLAN module) and connect air conditioner by CF mode again. Before rebooting, check nobody has already connected to same air conditioner.</p>
Mobile can't control air conditioner	<ol style="list-style-type: none">1. When air conditioner (WLAN module) is rebooted and app displays Device remove, ignoring this confirmation will lead to mobile device losing control permission of the air conditioner. You will need to connect the air conditioner by CF mode again.2. In case of power failure, mobile device will lose control permission of air conditioner for 3 minutes after power failure. (Notification will now show up on the mobile device.) If you cannot control the app (air conditioner) even after power restored, you will need to connect the air conditioner by CF mode again.
Mobile can't find air conditioner	<ol style="list-style-type: none">1. Smart Life App display Air conditioner Device offline. Please check the following conditions.<ol style="list-style-type: none">1)The air conditioner has been reconfigured.2)Air conditioner out of power.3)Router out of power.4) Air conditioner can't connect to router.5) Air conditioner can't connect to network through the router.6)Mobile device can't connect to network.2. After adding the device, it disappears in device list . Hold and slide down to refresh the device list. If it has no change, shut down the app and start again.

